

AVANI

Ratchada Bangkok

The Buzz of Bangkok



Welcome to Avani Ratchada Bangkok Hotel

Business, shopping, dining and diversions are on the doorstep of Avani Ratchada Bangkok Hotel. With the Rama 9 MRT underground station just outside and 30 minutes' drive to both airports, the hotel is right in the centre of it all.

Avani Ratchada Bangkok Hotel brings modern, convenient style to city stays, with 402 chic rooms with cool city art, divine dining all-day, top-notch dim sum, and total chill-out zones from the pool and the spa to the sauna.

- 11 meeting rooms including Grand Ballroom
- 2 restaurants and 2 bars
- Fitness centre and pool
- Fortune IT Lifestyle Mall in the same building
- Just 30 minutes from both airports



Rooms

Welcome to Avani Ratchada Bangkok Hotel, where living and working is effortless.

402 rooms and suites give you the option of the space you need, with convenient amenities to make your stay.

Room Type	Total		Room Size (sqm)	Accept Roll Away	Maximum Capacity
Deluxe Room	217 Rooms		30	Yes	3 Adults
	69 King	148 Twin			2 Adults + 1 Child
Deluxe Skyline	86 Rooms		30	Yes	3 Adults
	67 King	19 Twin			2 Adults + 1 Child
Executive Room	62 Rooms		30	Yes	3 Adults
	52 King	10 Twin			2 Adults + 1 Child
Junior Suite	14 Suites		46	Yes	3 Adults
	7 King	7 Twin			2 Adults + 1 Child
Skyline Suite	2 Suites		46	Yes	3 Adults
	2 King				2 Adults + 1 Child
Executive Suite	4 Suites		46	Yes	3 Adults
	2 King	2 Twin			2 Adults + 1 Child
One Bedroom Suite	14 Suites		68	Yes	3 Adults
	9 King	5 Twin			2 Adults + 1 Child
Two Bedroom Suite	2 Suites		130	Yes	6 Adults
	1 King	1 Twin			4 Adults + 2 Child
Presidential Suite	1 Suites		169	Yes	3 Adults
	1 King				2 Adults + 1 Child
Total	402 Rooms				

Live and work effortlessly in the heart of Bangkok's business district. You'll find rooms that are comfortable and modern, complete with high-tech amenities. Set up your laptop, kick back with a cocktail, and marvel at Bangkok's 24-hour vibes.



Deluxe Room

30 sqm – 217 rooms

By day, you'll find all the modern convenience to make your stay a breeze. By night, close the curtains on those sparkling city lights for a cozy sleep on the best beds in Bangkok.

Deluxe Skyline Room

30 sqm – 86 rooms

Stay contemporary, stay comfortable in this room in downtown Ratchada. With amazing panoramic city views, you can see the action going on below.

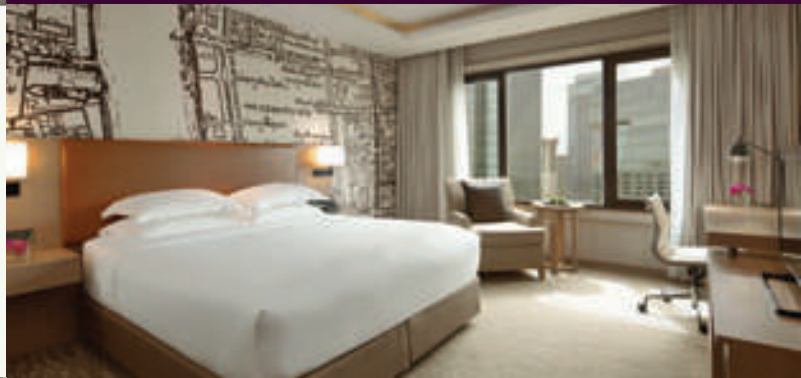

Executive Room

30 sqm – 62 rooms

Our Executive Rooms are ready for your work, rest and play. With everything you need for stylish stay near your Bangkok meetings. Hop under the shower for a wake-up then power on through your day. Make the most of AvaniClub benefits.



Junior Suite

47 sqm – 14 rooms

Bigger is better. Choose the suite life for more room to stretch out or cool down. Make the most of AvaniClub benefits. Grab a complimentary drink from the mini bar and chill on your huge cozy bed.

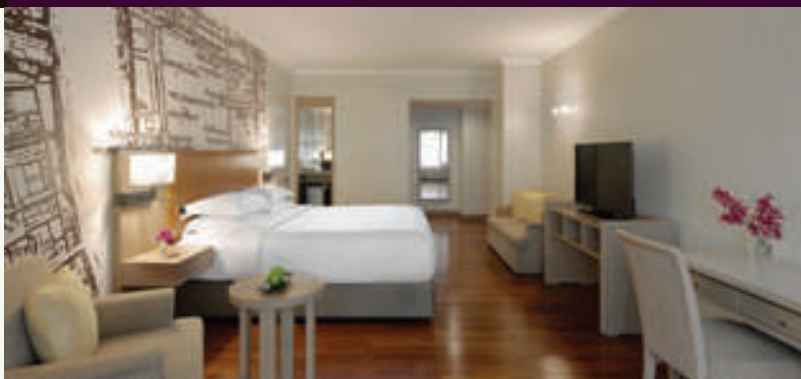

Skyline Suite

46 sqm – 2 rooms

Treat yourself to extra space to play. Enjoy the comfort and AvaniClub touches while still catching that view.





Executive Suite

46 sqm – 4 rooms

Comfort meets sophistication in this corner suite overlooking the city. Capture some snaps from your spacious retreat or get down to work at the well-positioned desk.

One Bedroom Suite

68 sqm – 14 rooms

With a private check-in and check-out, AvaniClub benefits and space to swing your bags around, this is living the suite life.



Two Bedroom Suite

130 sqm – 2 rooms

When you're bringing the family, choose the room to fit everyone. With separate areas for living, dining and sleeping, it's a comfy stay for all. The big bath has room invites you to sink into bubbles, then it's time to wind down for sweet dreams.



Presidential Suite

169 sqm – 1 rooms

Presidential Suite is the ultimate stay. You'll find top floor amenities and 180 views to impress. Entertain eight visitors at the dining table and whip up some cocktails at your in-suite bar. Then treat yourself to a relaxing sauna session beside your stylish bedroom.



Room Features

- All rooms and suites enjoy impressive city views
- Rooms and suites from level 14 and above
- King or twin beds
- In-room minibar
- Tea and coffee making facilities
- Personal safety box
- Complimentary internet Wifi
- Flat screen TV
- Bathtub in suites
- AvaniClub lounge for guests in Executive Rooms and Suites
- Meeting and banquet facilities
- Wedding event spaces
- Wellness facilities; AvaniFit, onsen, sauna and spa



Meeting, events & wedding

In town for business? We've got you covered. Our 11 meeting rooms are ideal for workshops and conferences. They're outfitted with the latest audiovisual technology, and we'd be happy to arrange any catering for you such as coffee breaks, business lunches or post-meeting cocktails.

This iconic venue has a capacity for:

- 1,000 delegates
- Car lift with direct access to Diamond Grand Ballroom a weight load of 2,000 kg. The size of the car lift is 2 x 4 x 1.6 m.

Grand Diamond Ballroom

Modern, elegant and equipped to cater for up to 700 guests, this impressive space is ideal for large company events and launches.



Platinum Hall

Flexible and accommodating, this room is brightly lit and brilliant for your large training event or company annual party. Designed to engage your delegates.



Silver Rooms







Modern and equipped with multi-media. Whether you want a corporate retreat or a fun day away from the office, this choice fits the bill for a variety of needs.

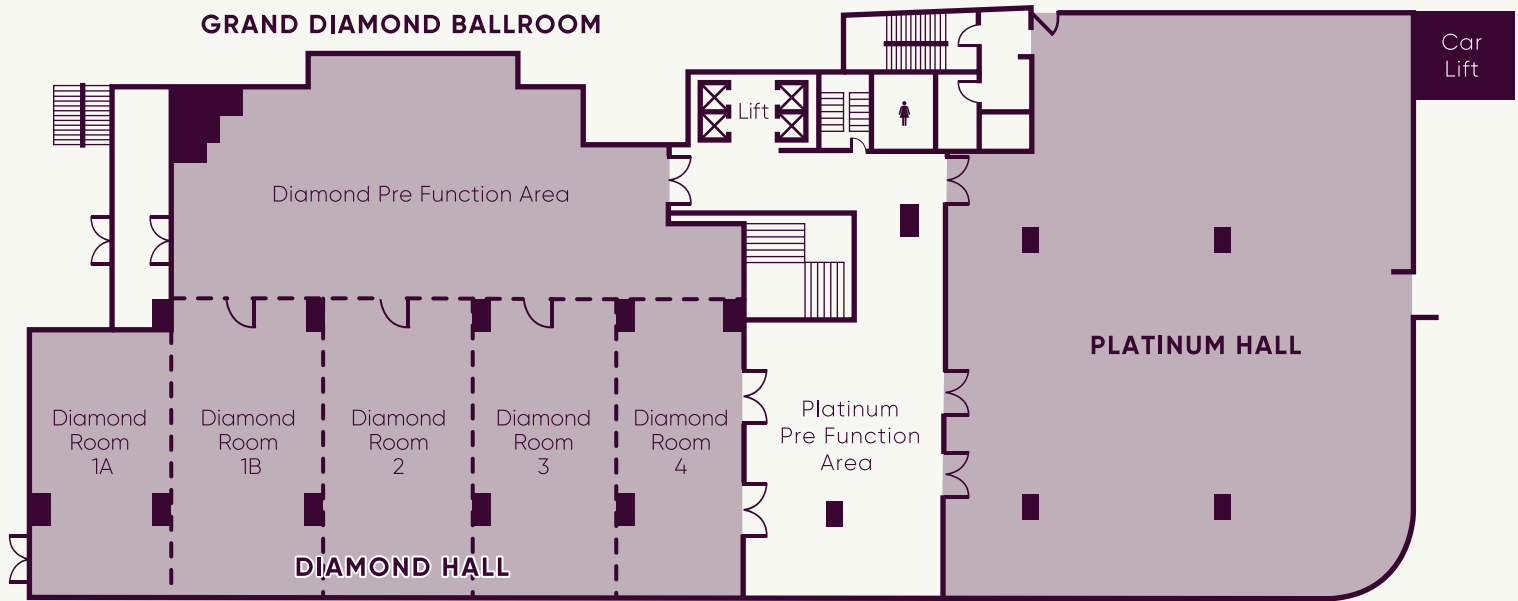

Conference Facilities

3th FLOOR





Names	Area		Dimensions (W x L x H)		Seating Options						
	M ²	F ²	M.	Ft.	Theatre	Classroom	U-Shape	Boardroom	Banquet	Cocktail	Cabaret
											
GRAND DIAMOND BALLROOM	814	9216	24 x 38.5 x 3.3	79 x 126 x 11	700	350	-	-	450	700	270
• Diamond Pre Function Area	190	2874	10 x 30 x 3.3	33 x 98 x 11	100	70	-	-	80	100	50
• Diamond Hall	539	5796	14 x 38.5 x 3.3	46 x 126 x 11	400	220	-	-	320	400	180
- Diamond Room 1A & 1B	217	2346	15.5 x 14 x 3.3	51 x 46 x 11	100	60	40	20	80	100	48
- Diamond Room 2	112	1196	8 x 14 x 3.3	26 x 46 x 11	60	36	35	20	40	40	30
- Diamond Room 3	112	1196	8 x 14 x 3.3	26 x 46 x 11	60	36	35	20	40	40	30
- Diamond Room 4	98	1058	7 x 14 x 3.3	23 x 46 x 11	60	36	35	20	40	40	30
PLATINUM HALL	450	5084	19 x 25 x 3.3	62 x 82 x 11	300	150	60	40	200	250	120
Platinum Pre Function Area	138	1476	12.5 x 11 x 3	41 x 36 x 10	-	-	-	-	-	-	-

Conference Facilities

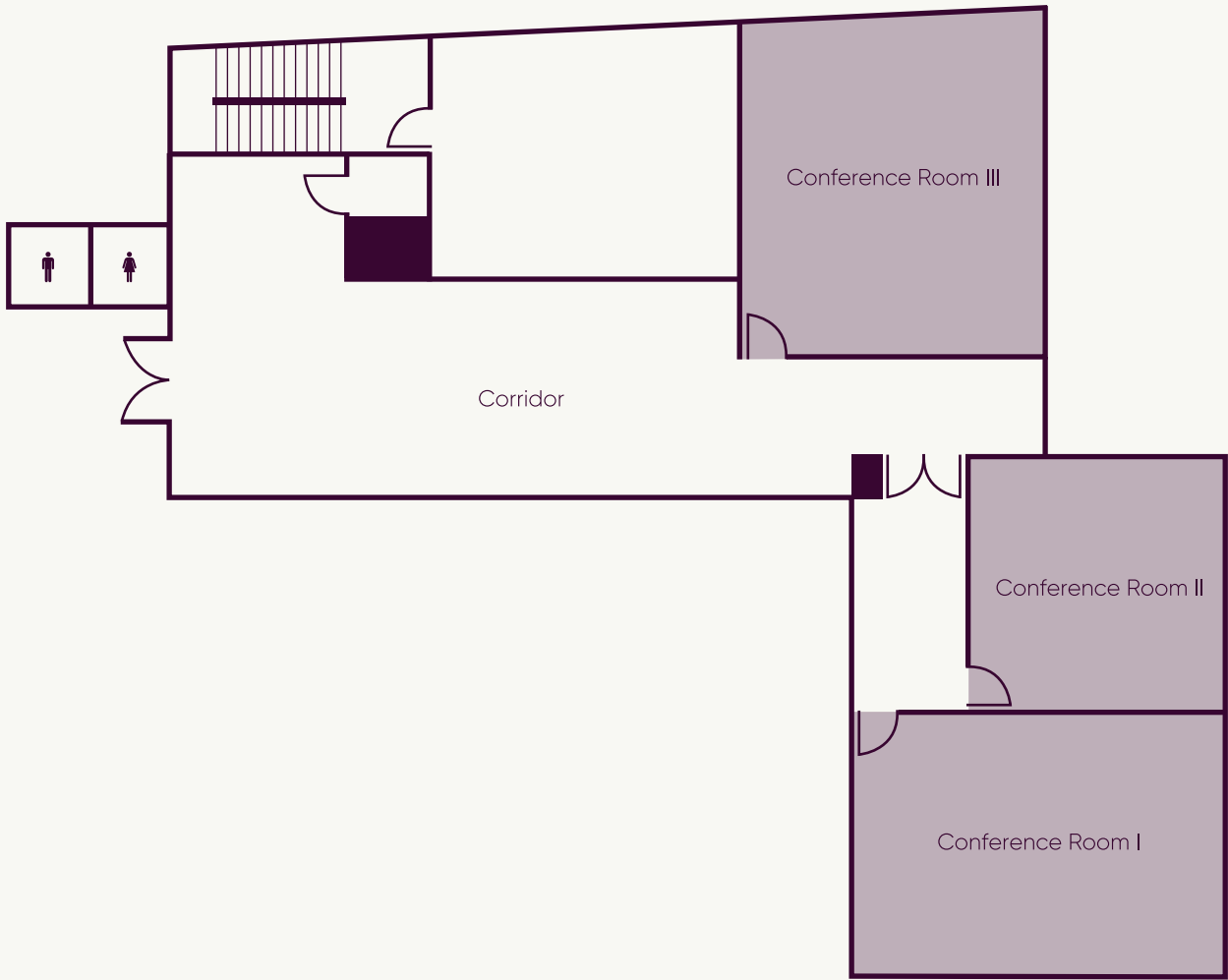
2nd FLOOR







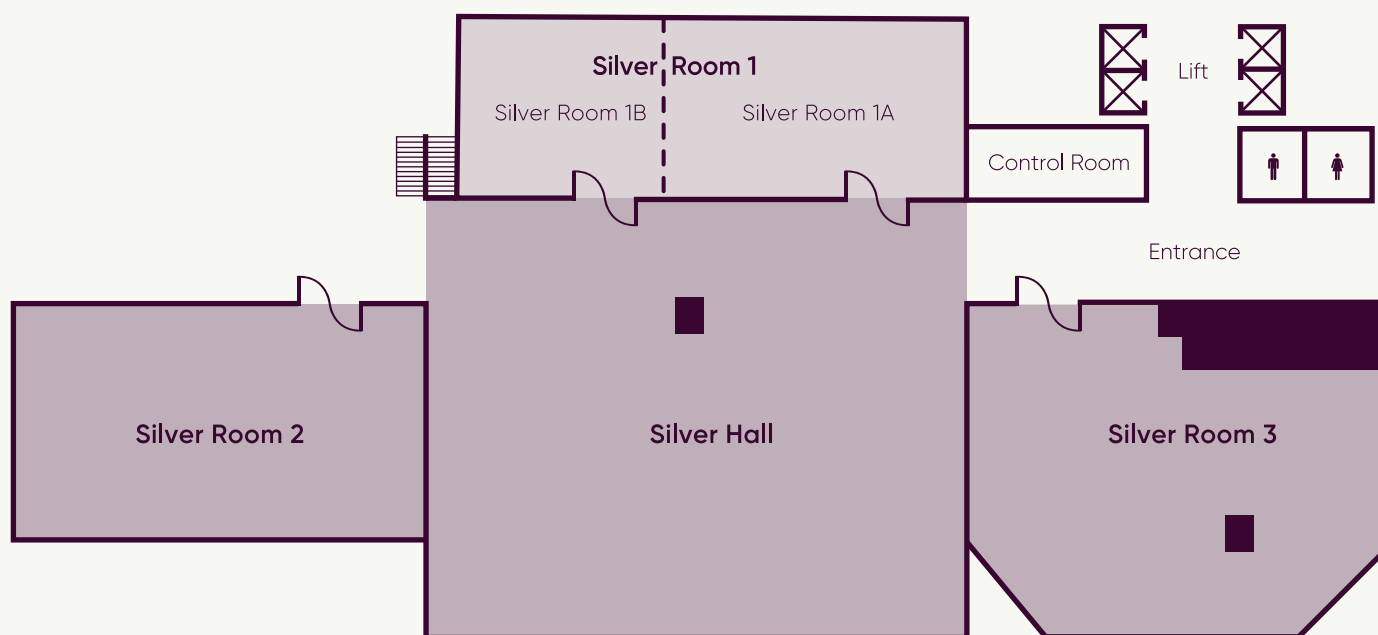

Names	Area		Dimensions (W x L x H)		Seating Options						
	M ²	F ²	M.	Ft.	Theatre	Classroom	U-Shape	Boardroom	Banquet	Cocktail	Cabaret
											
Conference Room I	48	520	6 x 8 x 2.8	20 x 26 x 9	20	14	16	-	-	-	-
Conference Room II	33	360	6 x 5.5 x 2.8	20 x 18 x 9	16	12	10	-	-	-	-
Conference Room III	54	575	7.7 x 7 x 2.8	25 x 23 x 9	20	14	16	-	-	-	-

Conference Facilities

BASEMENT



Names	Area		Dimensions (W x L x H)		Seating Options						
	M ²	F ²	M.	Ft.	Theatre	Classroom	U-Shape	Boardroom	Banquet	Cocktail	Cabaret
											
Silver Room 1	154	1650	7.7 x 20 x 2.4	25 x 66 x 8	80	50	30	30	60	80	36
• Silver Room 1A	92	975	7.7 x 12 x 2.4	25 x 39 x 8	50	30	20	20	40	50	24
• Silver Room 1B	62	650	7.7 x 8 x 2.4	25 x 26 x 8	40	20	15	15	30	40	18
Silver Room 2	160	1749	10 x 16 x 2.4	33 x 53 x 8	70	50	30	30	60	70	36
Silver Room 3	208	2279	13 x 16 x 2.4	43 x 53 x 8	70	50	30	30	60	70	36
Silver Hall	270	2904	13.5 x 20 x 2.4	44 x 66 x 8	80	50	30	30	60	80	36



Wine & Dine

You'll find no shortage of choice when it comes to eating at Avani Ratchada. From world renowned favourites at One Ratchada International to impeccable Chinese specialities at Nan Yuan or cosy snacks at Metro Lounge, variety is on the menu. Find freshness by the pool or order to your room.



One Ratchada

International
Daily 6:00 a.m. – 10:00 p.m.

Fresh and flavourful from daybreak, One Ratchada offers premium ingredients and great dishes throughout the day. Begin with a breakfast buffet brimming with options from Asia to America. Return for lunch of pasta, grilled meats, salads or seafood. By night, enjoy contemporary plates created by our culinary team.



Nan Yuan

Traditional Cantonese Cuisine
Daily 11:30 a.m. – 2:30 p.m. and 5:30 p.m. – 10:00 p.m.

Favoured by Bangkok's foremost diners, this authentic Chinese restaurant delivers a fulfilling experience. Share endless dim sum over lunch or sample the tender Peking duck. Book one of four private rooms for an exclusive gathering and delight your guests with the finest Cantonese food.



Metro Lounge

Sip and smooth
Daily 8:00 a.m. – midnight

A stylish haunt beside our lobby, big comfy chairs welcome you any time. Expertly prepared drinks are on offer with a flick of our mixologist's wrists. Conduct a casual meeting by day or join colleagues to wind down to the sounds of live music every Wednesday to Saturday evening.



The Pantry

Fresh and tasty snacks
Daily 8:00 a.m. – 9:00 p.m.

The Pantry has quick bites to fill you up on the go. There are sandwiches that'll conquer your cravings and pastries so fresh they practically sing. Top it all off with a celebratory pound cake - perfect for anything you can dream up!



Sun Deck

Swim, play, eat, repeat
Daily 10:00 a.m. – 8:00 p.m.

Head to the 12th floor pool bar for cool drinks overlooking the city. Ideal for a swim and a snack or a fruity mix to float away with. Take some shade from the sunshine or watch as Bangkok's sky lights up in sunset.



AvaniFit

Daily 6:00 a.m. – 10:00 p.m.

When it's time to hit the gym, you'll find everything you need at our 12th floor fitness centre. Our modern facilities are full of natural light so you can run on the treadmill with garden views. Pump some iron or try a Thai boxing class. Cool down with a swim to stretch your muscles after your workout. Feel the benefit of minerals in our Onsen or indulge in a sauna session for those hidden health benefits.

Location

Our location on Ratchadapisek Road puts you at the centre of everything, with MRT Rama 9 station on the doorstep and the Makkasan Airport Rail Link nearby to connect to Suvarnabhumi International Airport. We're in the same building as The Fortune Town IT Lifestyle mall and opposite Central Rama 9. We're located in the Central Business District and surrounded by shopping centres so you can explore on foot or take a taxi for longer distances.

- MRT Rama 9 station on the doorstep
- Fortune IT Lifestyle Mall in the same building
- Opposite Central Rama 9 Department Store
- Three MRT stations away from Queen Sirikit National Convention Center (QSNCC)
- Opposite Jodd Fair
- 2 km or one MRT station away from Thailand Cultural Center
- 3.5 km from RCA Alley

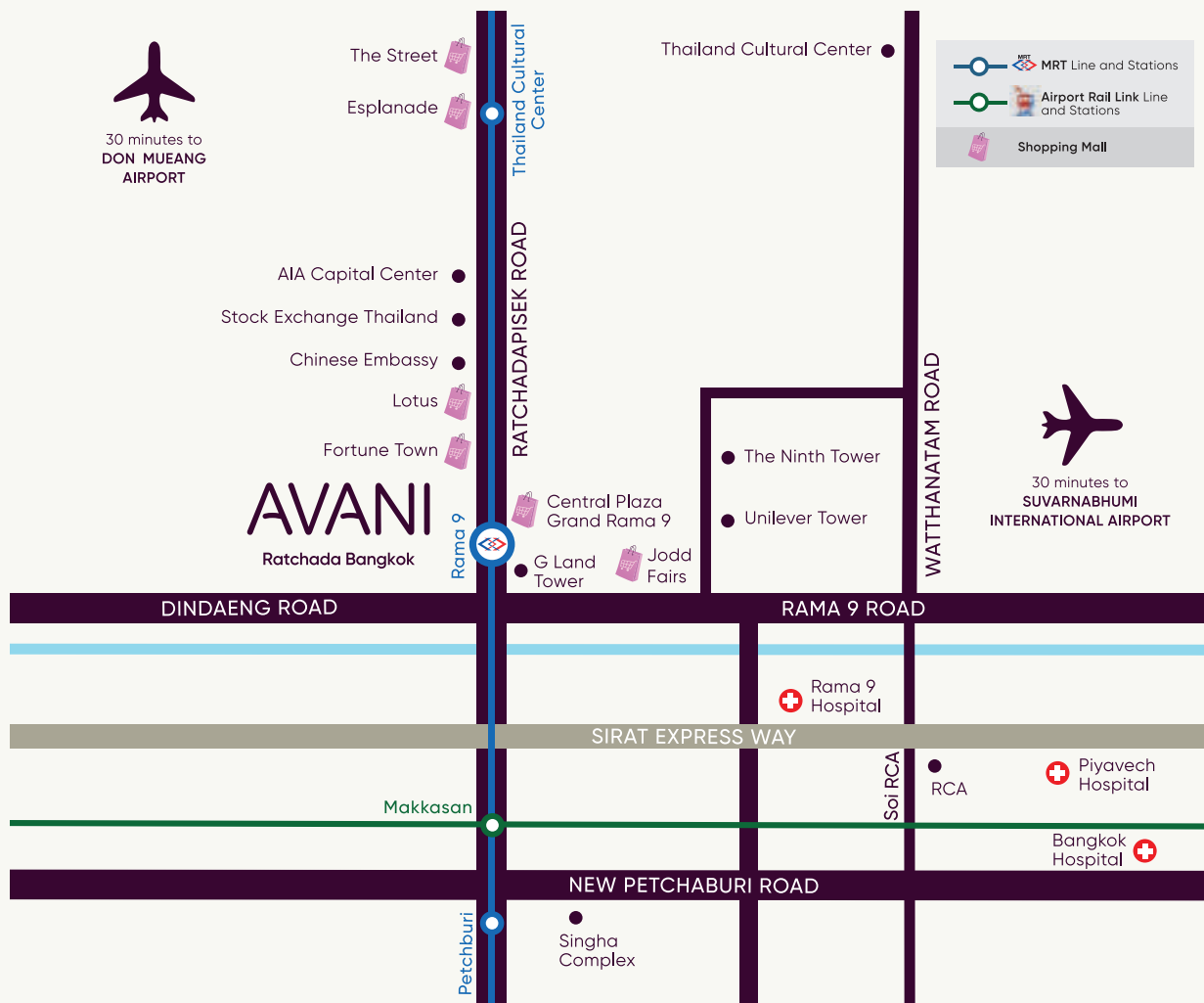

Avani Ratchada Bangkok

1 Ratchadapisek Road, Din Daeng, Bangkok 10400 Thailand

T: +66 2 641 1500

E: sales.varat@ananihotels.com

Line Official Account: @avaniratchada

AVANIHOTELS.COM